



名古屋ダイヤモンド工業株式会社  
Nagoya, Japan

# Multi-Point Diamond Dresser



■Multi-point Diamond Dressers consist of number of natural diamonds of a good crystal character fixed into a special wear resistant bond. Several diamond points in contact with the wheel face, reduce the unit pressure on each point resulting in a longer tool life with full utilization. Multi-point diamond dressers are used for larger wide grinding wheel.

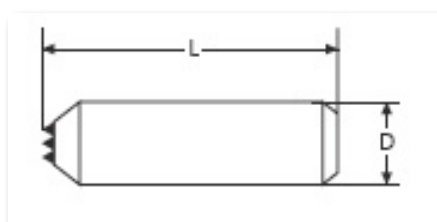

Diamond Quantity Order No.	App. Weight of Carat	Shank	Diamond Distribution	
3	1.00CT	ø12 x 100L	▲▲▲	MPDD301
3	1.00CT	ø12 x 100L	▲▲	MPDD302
5	1.25CT	ø12 x 100L	▲▲	MPDD501
6	1.50CT	ø12 x 100L	▲▲▲	MPDD601
7	2.00CT	ø12 x 100L	▲▲▲	MPDD701