



Ø 150x25x0.30 mm
Ø 6" x 1" x .012"

/ 02

Wire Brushes

2.1

CRIMPED WIRE WHEELS

CT Wide Face Wheel

WIRE BRUSHES / CRIMPED WIRE WHEELS

See construction drawing on page 84



Diameter (d)	Face Width (a)	Trim Length (s)	Multi Arbor Hole (e)	Coated Steel				Stainless Steel		Brass .012"	R.P.M. Max.
				.008"	.012"	.016"	.020"	.008"	.012"		
4"	1/2"	11/16"	1/2" 5/8"	21380	21300	21350	21310	21340	21330	21360	6,500
	9/16"		3/4" 7/8"	21480	21400	21450	21410	21440	21430	21460	
	5/8"		1" 1-3/16"	21580	21500	21550	21510	21540	21530	21560	
	7/8"			21780	21700	21750	21710	21740	21730	21760	
5"	1/2"	1-5/32"	1/2" 5/8"	22380	22300	22350	22310	22340	22330	22360	6,500
	5/8"		3/4" 7/8"	22480	22400	22450	22410	22440	22430	22460	
	3/4"		1" 1-3/16"	22580	22500	22550	22510	22540	22530	22560	
	1"			22780	22700	22750	22710	22740	22730	22760	
6"	5/8"	1-1/8"	1/2" 5/8"	23480	23400	23450	23410	23440	23430	23460	6,500
	3/4"		3/4" 7/8"	23580	23500	23550	-	23540	23530	23560	
	1"		1" 1-3/16"	23780	23700	23750	23710	23740	23730	23760	
	1-1/4"		2"	23980	23900	23950	23910	23940	23930	23960	
7"	11/16"	1-5/8"	1/2" 5/8"	24480	24400	24450	24410	24440	24430	24460	6,500
	3/4"		3/4" 7/8"	24580	24500	24550	-	24540	24530	24560	
	1-1/16"		1" 1-3/16"	24780	24700	24750	24710	24740	24730	24760	
	1-1/4"		2"	24980	24900	24950	24910	24940	24930	24960	
8"	11/16"	1-5/8"	1/2" 5/8"	25480	25400	25450	25410	25440	25430	25460	4,500
	3/4"		3/4" 7/8"	25580	25500	25550	-	25540	25530	25560	
	1"		1" 1-3/16"	25680	25600	25650	25610	25640	25630	25660	
	1-1/16"		2"	25780	25700	25750	25710	25740	25730	25760	
9"	1-3/8"	2-1/16"		25980	25900	25950	25910	25940	25930	25960	3,600
	3/4"		1/2" 5/8"	26480	26400	26450	26410	26440	26430	26460	
	7/8"		3/4" 7/8"	26580	26500	26550	26510	26540	26530	26560	
	1-1/16"		1" 1-3/16"	26680	26600	26650	26610	26640	26630	26660	
	1-1/8"		2"	26780	26700	26750	26710	26740	26730	26760	
1-3/8"			26980	26900	26950	26910	26940	26930	26960		

Diameter (d)	Face Width (a)	Trim Length (s)	Multi Arbor Hole (e)	Coated Steel				Stainless Steel		Brass	R.P.M. Max.
				.008"	.012"	.016"	.020"	.008"	.012"	.012"	
10"	7/8"	2-5/8"	1/2" 5/8" 3/4" 7/8" 1" 1-3/16" 2"	27480	27400	27450	27410	27440	27430	27460	3,600
	1"			27580	27500	27550	27510	27540	27530	27560	
	1-1/8"			27680	27600	27650	27610	27640	27630	27660	
	1-3/8"			27780	27700	27750	27710	27740	27730	27760	
	1-1/2"			27980	27900	27950	27910	27940	27930	27960	
12"	7/8"	3-5/8"	1/2" 5/8" 3/4" 7/8" 1" 1-3/16" 2"	29480	29400	29450	29410	29440	29430	29460	3,000
	1"			29580	29500	29550	29510	29540	29530	29560	
	1-3/4"			29680	29600	29650	29610	29640	29630	29660	
	1-3/8"			29780	29700	29750	29710	29740	29730	29760	
	1-1/2"			29980	29900	29950	29910	29940	29930	29960	
14"	7/8"	4-5/8"	1/2" 5/8" 3/4" 7/8" 1" 1-3/16" 2"	20480	20400	20450	20410	20440	20430	20460	2,400
	1-1/16"			20580	20500	20550	20510	20540	20530	20560	
	1-1/4"			20680	20600	20650	20610	20640	20630	20660	
	1-1/2"			20780	20700	20750	20710	20740	20730	20760	
	1-5/8"			20980	20900	20950	20910	20940	20930	20960	

Note: Face width measures are always approximate. Brushes made on request will indicate all necessary specifications on the side plates.

CT Wide Face Wheel with Multi-Fitting Adaptor

WIRE BRUSHES / CRIMPED WIRE WHEELS

Multi-Fitting Arbor Hole (7 different sizes)

- 1/2", 5/8", 3/4", 7/8", 1", 1-3/16", 2"
- Allows one brush to fit (7) seven different arbor sizes just by knocking out the arbor hole bushings. Reduces inventory, no adaptor inventory and increases order accuracy.



Technical Information CT

- These wheels are designed for individual use or can be mounted on a shaft.
- Available in a wide variety of diameters, face widths, arbor holes and wire fills.

Applications CT

- Removal of rust, paint, scale, edges, etc.
- Cleaning of forged pieces
- Tire recovery
- Surface processing in metal, rubber, plastic, wood, glass, etc.
- Light deburring
- Edge blending



CT With Threaded Nut

WIRE BRUSHES / CRIMPED WIRE WHEELS



JAZ offers a range of 3/4" face width, .012" brass coated steel brushes in 6", 7" and 8" diameter that are equipped with a 5/8"-11 threaded nut. This allows the operator to easily mount the crimped wheel brush to portable angle grinders.

Part No: 23502

24502

25502



CT brush models are packaged in our exclusive security handling system



CU Narrow Face Wheel 3 Rows – Face Width of 11 mm (7/16")

WIRE BRUSHES / CRIMPED WIRE WHEELS



Diameter (d)	Trim Length (s)	Coated Steel				Stainless Steel		Brass .012"	R.P.M. Max.
		.006"	.008"	.012"	.016"	.008"	.012"		
4"	3/4"	CU1003B	CU1003C	CU1003E	CU1003G	CU1003N	CU1003Z	CU1003V	6,000
5"	7/8"	CU1203B	CU1203C	CU1203E	CU1203G	CU1203N	CU1203Z	CU1203V	6,000
6"	1-1/8"	CU1503B	CU1503C	CU1503E	CU1503G	CU1503N	CU1503Z	CU1503V	6,000
7"	1-5/8"	CU1703B	CU1703C	CU1703E	CU1703G	CU1703N	CU1703Z	CU1703V	6,000
8"	2-1/16"	CU2003B	CU2003C	CU2003E	CU2003G	CU2003N	CU2003Z	CU2003V	4,500
9"	2"	CU2203B	CU2203C	CU2203E	CU2203G	CU2203N	CU2203Z	CU2203V	3,600
10"	2-3/8"	CU2503B	CU2503C	CU2503E	CU2503G	CU2503N	CU2503Z	CU2503V	3,600
12"	3-3/8"	CU3003B	CU3003C	CU3003E	CU3003G	CU3003N	CU3003Z	CU3003V	3,000

Note: R.P.M. specifications vary when several brushes are put together in a roller.

We have drive shafts with keyways. You can make us an enquiry.

Axis description

Brush Diameter	4" - 5"		6"-7"-8"		9"-10"-12"	
Fixed Arbor Hole (e)	1/2", 5/8", 3/4", 1"	1/2", 5/8", 3/4", 7/8", 1"	1-3/16", 1-3/8", 1-5/8", 2"	5/8", 3/4", 7/8", 1"	1-3/16", 1-3/8", 1-5/8", 2"	

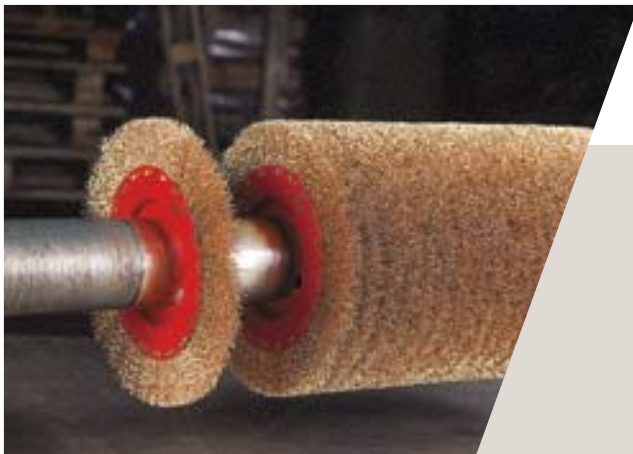

- The CU brushes can be stacked as shown in the picture
- Must be taken into account that on each end of each block of stacked brushes that side plates must be used and should be the same diameter as the CU side plates.
- The thickness of the plates should be robust enough taking into account the applications RPMs, etc.

CU Narrow Face Wheel 4 Rows – Face Width of 13 mm (1/2")

WIRE BRUSHES / CRIMPED WIRE WHEELS



Diameter (d)	Trim Length (s)	Coated Steel					Stainless Steel		Brass	R.P.M. max.
		.006"	.008"	.012"	.016"	.020"	.008"	.012"	.012"	
10"	1"	CU92504B	CU92504C	CU92504E	CU92504G	CU92504H	CU92504N	CU92504Z	CU92504V	3.600
11"	2"	CU92754B	CU92754C	CU92754E	CU92754G	CU92754H	CU92754N	CU92754Z	CU92754V	3.600
12"	2-3/8"	CU93004B	CU93004C	CU93004E	CU93004G	CU93004H	CU93004N	CU93004Z	CU93004V	3.600
13"	3"	CU93254B	CU93254C	CU93254E	CU93254G	CU93254H	CU93254N	CU93254Z	CU93254V	3.600
14"	3-1/4"	CU93504B	CU93504C	CU93504E	CU93504G	CU93504H	CU93504N	CU93504Z	CU93504V	3.000
16"	4-11/32"	CU94004B	CU94004C	CU94004E	CU94004G	CU94004H	CU94004N	CU94004Z	CU94004V	3.000

Note: R.P.M. specifications vary when several brushes are put together in a roller.
We have drive shafts with keyways. You can make us an enquiry.

Axis description

Brush Diameter	10" - 16"
Fixed Arbor Hole (e)	2", 3-1/8", 3-1/4", 4.11/32"

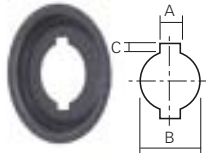

INSIDE DIAMETER with keyways			
Diameter (B)	KEYway (A)	KEYway (C)	Code
2"	1/2"	9/32"	51
2-5/32"	1/2"	1/4"	55
3-1/8"	7/8"	1/4"	80
3-1/4"	7/8"	9/32"	83
4-11/32"			110



order example:
CU 1503E 16
 1. Model: **CU**
 2. Article Code: **1503**
 3. Wire Code: **E**
 4. Arbor Hole: **16 mm**

Technical Information CU

- Specially designed for making rollers by stacking individual brushes.
- Special models are available for wide rollers and the availability of arbor holes with key ways.
- When used individually they are best for brushing narrow areas.

Applications CU

- Removal of rust, paint and scale
- Edge cleaning of tubes and sections, manually or on automated machines (R.S.A., ADIGE, etc. machine types). Automatically